



THE HELIOTROPE 105

Majestic Superyacht

The Heliotrope 105 Power Catamaran offers a fusion of elegance, functionality and space to match your own individual tastes and specifications. Just as you are a unique individual with specific needs and desires, so the Heliotrope 105 is essentially a global cruising platform that can be built and furnished to match your every desire. With unique configuration, equipment, furnishings and facilities that reflect your own specific needs, your new global cruising catamaran becomes a true reflection of your success, taste and high standards.



Each custom-built yacht is constructed by Bakricono at their yard on Thailand's Gulf of Siam in collaboration with naval architect Albert Nazarov of Albatross Marine to match the highest global standards.

Certainly, the Heliotrope 105 is a perfect world cruiser with great flexibility and spacious luxury able to accommodate and entertain large gatherings of family, friends and guests. Equally, the unique blend of functionality and elegance is ideal for business use, or even as a waterborne home.

This super yacht is truly a "statement craft" featuring a living room of 135 sqm, topped with the owner's private suite of over 85 sqm which allows direct access to a fitness room, spa, private saloon, private terrace and dining room including elevator.

The Heliotrope 105's unique blend of practicality and cutting-edge luxury utilises both turbo diesel and thru electrical propulsion. If desired she can be fitted with the most advanced solar panel systems throughout from which all electricity and electrical systems can be managed, as befits an owner who loves the world's oceans and wishes to foster their protection through responsible cruising and environmental protection.



MAIN PARTICULARS

PARAMETER	SYMBOL	VALUE	
LENGTH			
Maximum length.....	L_{MAX}	32.40 m	98 ft.
Length of hull	L_H	30.60 m	91 ft.
Length of waterline.....	L_{WL}	29.60 m	88.80 ft.
BEAM			
Maximum beam.....	B_{MAX}	12.00 m	36 ft.
Beam at waterline.....	B_{WL}	2.40 m	7.2 ft.
Beam between hauls CL.....	B_{CL}	8.40 m	25.2 ft.
DEPTH			
Midship depth.....	$D_{LWL/2}$	4.21 m	13.8 ft.
DRAUGHT			
Minimum draught (lightship).....	T_{MN}	0.90 m	2.7 ft.
Maximum draught (loaded).....	T_{MAX}	1.10 m	3.30 ft.
HEIGHT			
Air draught (at DWL to top of mast).....	HA	11.50 m	34.5 ft.
Bridgedeck height (vertical clearance).....		1.00 m	
DISPLACEMENT			
Loaded craft displacement (LDL).....	mLDL	150000 kg.	300,000 Lb
ENGINE			
Number of engines.....		2	
Power.....		2x2000 HP	
PERFORMANCE			
Maximum design speed (LDL condition).....		25 kts.	
Recommended cruising speed		20 kts.	
TANKAGE			
Fuel		20000 L	5'250 gal
Water		8000 L	2'100 gal
PASSENGERS/CREW			
Passengers		12	
Crew		5	

All measurement according to ISO8666
 DWL corresponds to LDC (Loaded Displacement Condition)

Design Notes: FEATURES

- Balcony
- Dumb waiter
- Spiral ladders
- Access for owner, guests and crew
- Jet ski and tender garage
- Sundecks

Design Notes: SAFETY

- Expertise of catamaran design
- Designed to MCA LY2 code
- Structure designed to GL
- Fire safety
- Passive safety

Design Notes: STYLING

- No extreme
- Resale value
- Usable
- Close to classic
- Buildable
- Only proven solutions



More Styling Options

Design Notes: FUNCTIONALITY

- Designed for luxury cruising and life on board in tropics
- Space!
- Natural air flow
- Protection from direct sunlight
- Headroom, ergonomics to housing standards
- Privacy
- Toys on board
- Performance and sea keeping

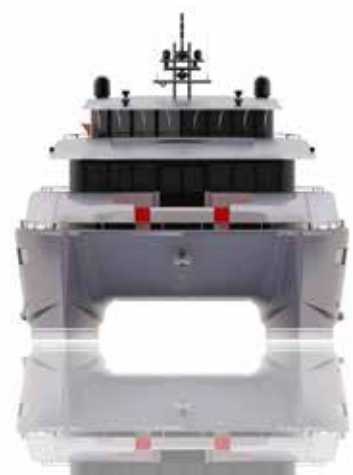

Design Notes: SPACE PLANNING

MAIN ZONES

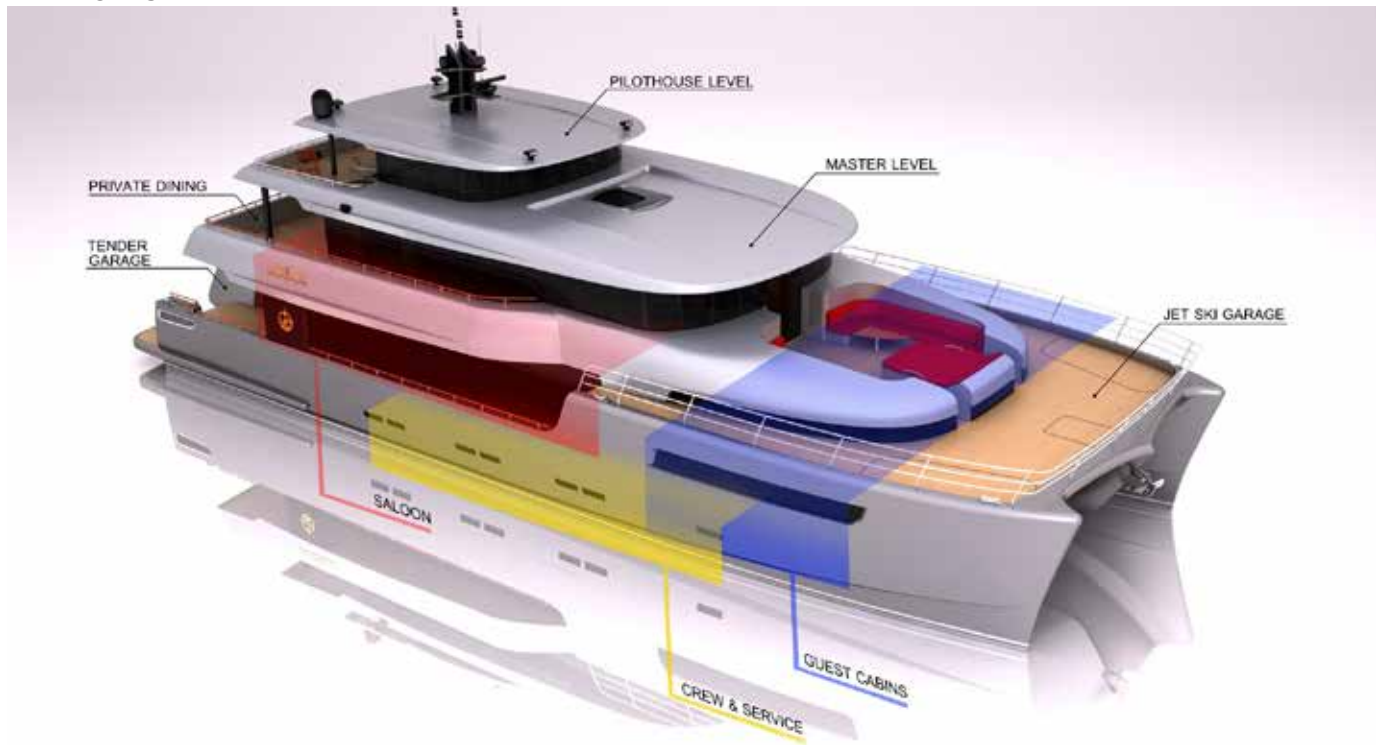

Main deck

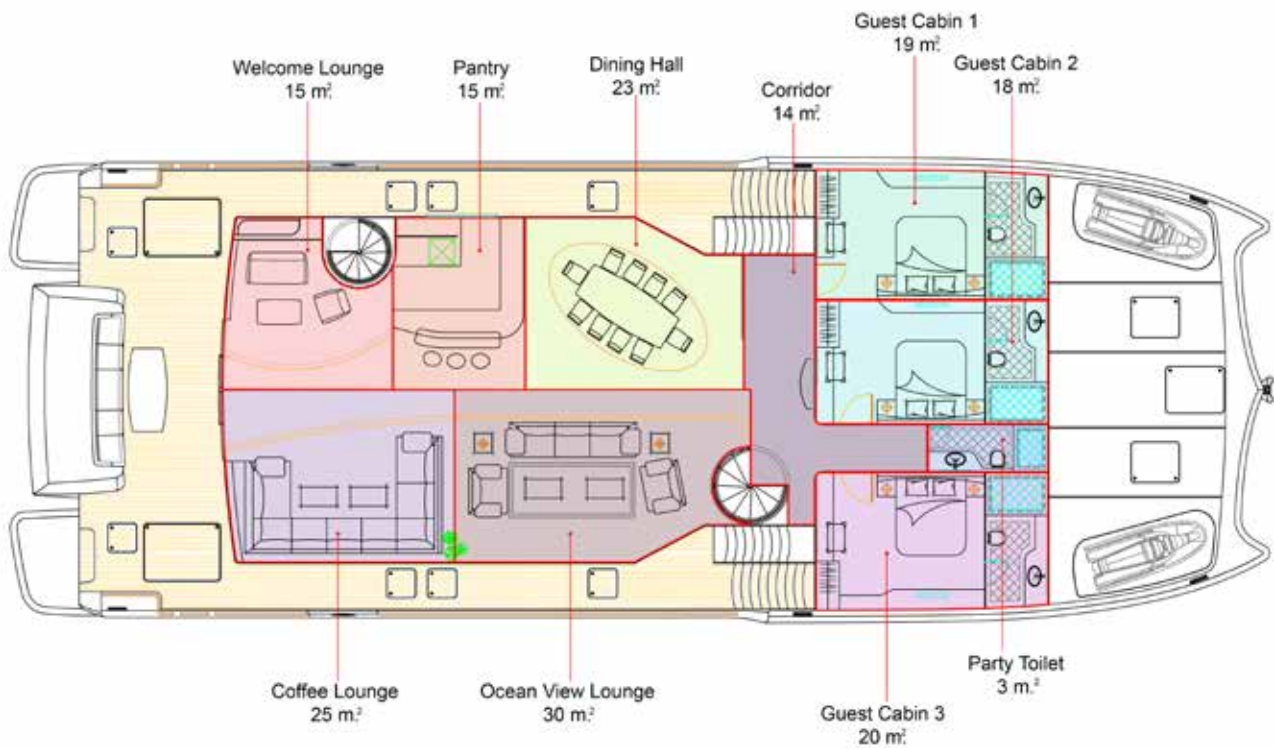

Master level (upper deck)

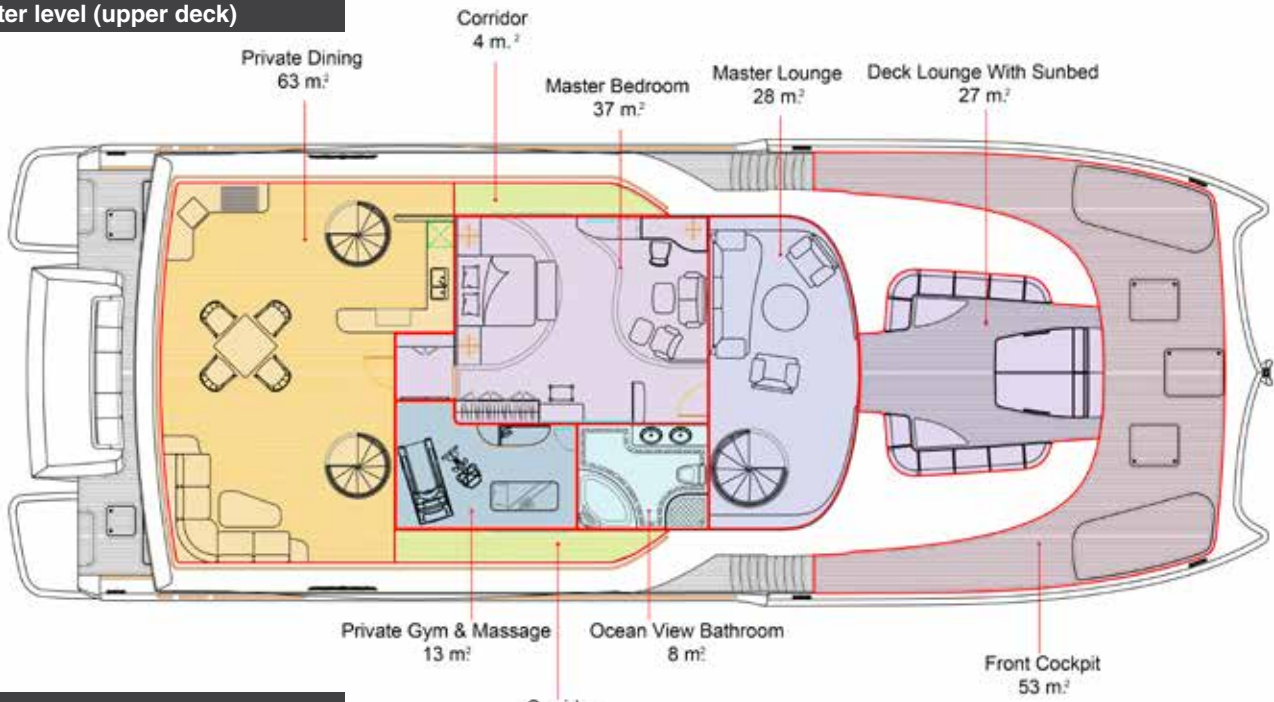

Pilothouse level (flybridge deck)

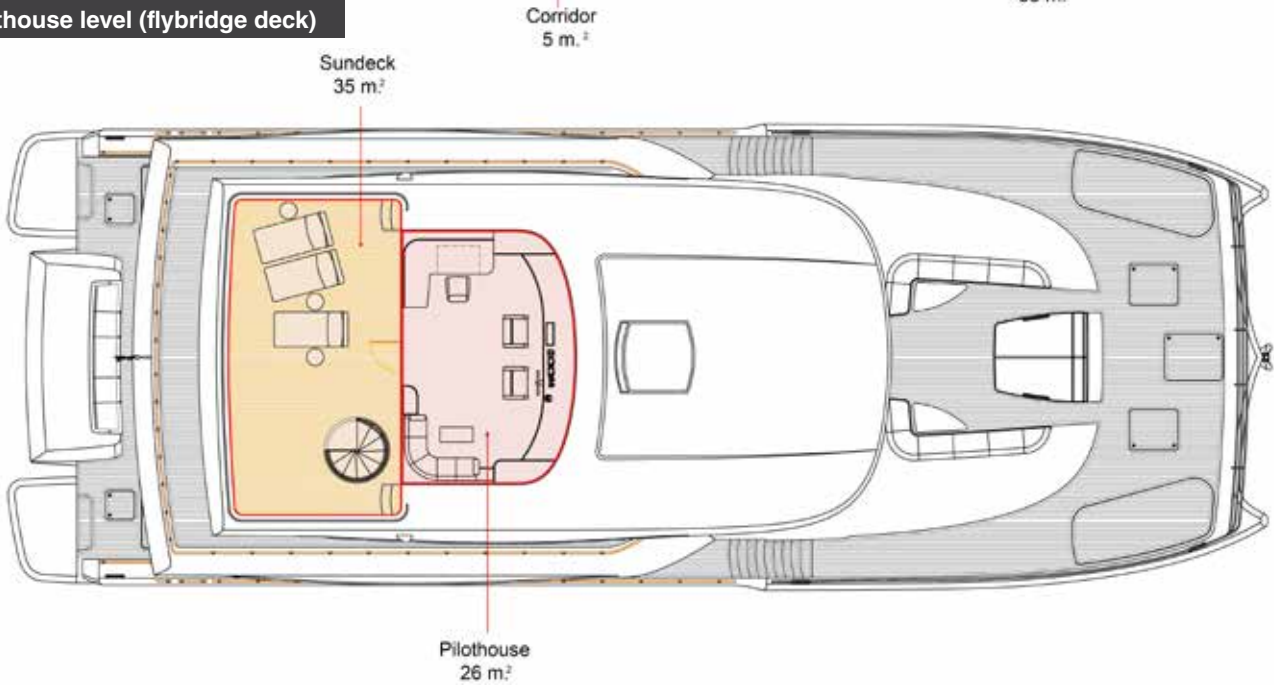

Crew & service (lower deck)

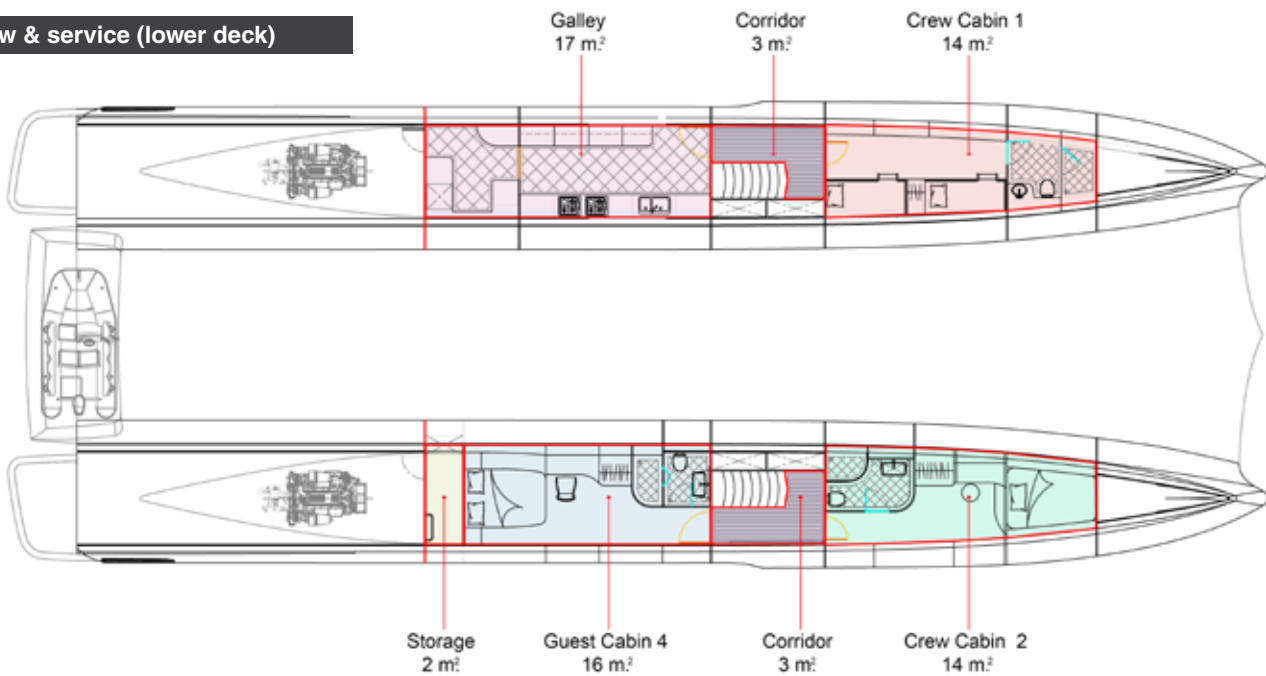

Design Notes: INTERIOR DESIGN OPTION



Saloon – Modern Look



Saloon – looking AFT



Saloon – Oriental Look 1



Saloon – looking FWD



Saloon – Oriental Look 2



Master Cabin 1



Master Cabin 2

The information of products and details mentioned before may be subject to change and are only indicative. 2016